

(440)

State of S^c Carolina
 Pinkney District
 Pursuant to a warrant
 from John Thomas, Com^r of
 loc^o 13th Dec^r 1791. I have
 laid out unto Ludo^s &
 Ford a tract of two hundred
 & fifty acres of land
 in Spartanburg county on
 Innotree Creek of Enoree river
 running E^{ly} & N^W with James Ford's
 land N^W & S^E with Perry Andersons
 and John Rarringtons land
 and both such shape and marks
 as the above plat represents.
 Survey^d 3rd Jan^y 1792.
 Recorded 5th June 1796.

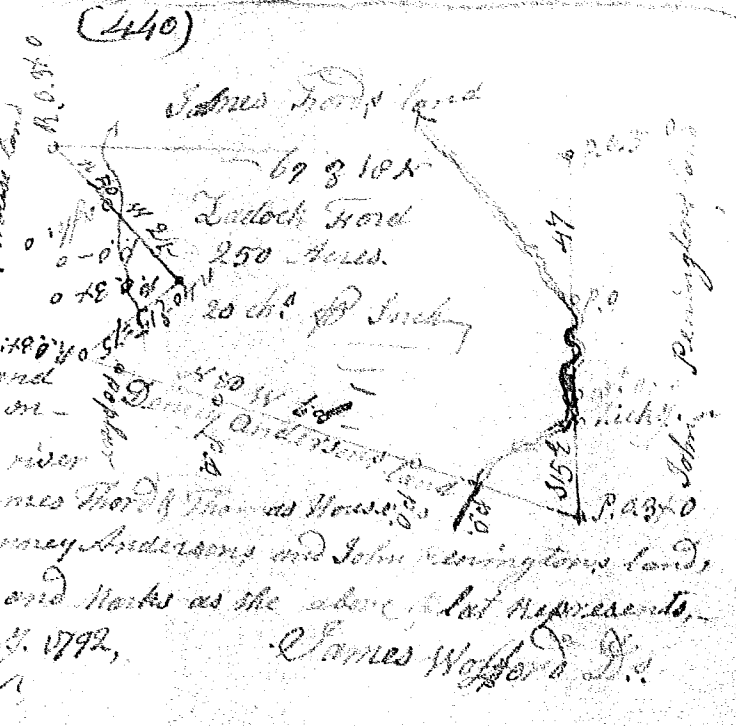

South Carolina Pursuant to a warrant from
 John Thomas, Com^r of loc^o 13th Saluda dated
 20th May 1790. I have admeasured and laid out
 unto James Smith a tract of three hundred &
 fifty nine acres of land in Pinkney District
 in Spartanburg County on bridge branch, waters
 of S^c Saluda riv^r. Bounded by the following
 S^W by land sur^v for Dickson & M^r Towel S^W
 and W by land S^W for J. Curver. N^W by the
 Alexander St, S^W & N^E by Hendersons land
 all other sides Vacant
 and both form & marks
 as the above plat
 represents.
 Survey^d 20th May 1792.

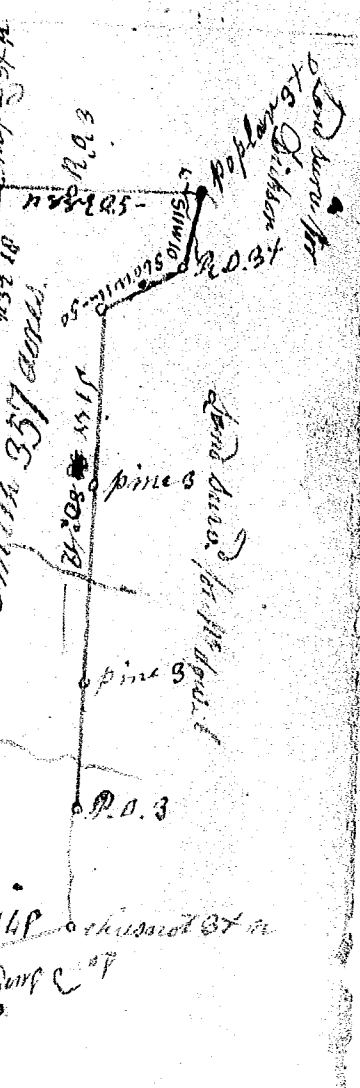

J. Gab^l Benson
 Recorded 13th July 1792